

FILED
C.E. Johnson
 City Engineer

PLAN & PROFILE No. 713
 FOR
IMPROVEMENT
 OF
WATERS STREET
 FROM G ST. TO H ST.
 IN THE
CITY OF SAN BERNARDINO,
 CALIFORNIA.

October, 1924. C.E. Johnson, City Engineer.
 Scale: Plan 1" = 40', Profile (Horizontal) 1" = 40', (Vertical) 1" = 6'

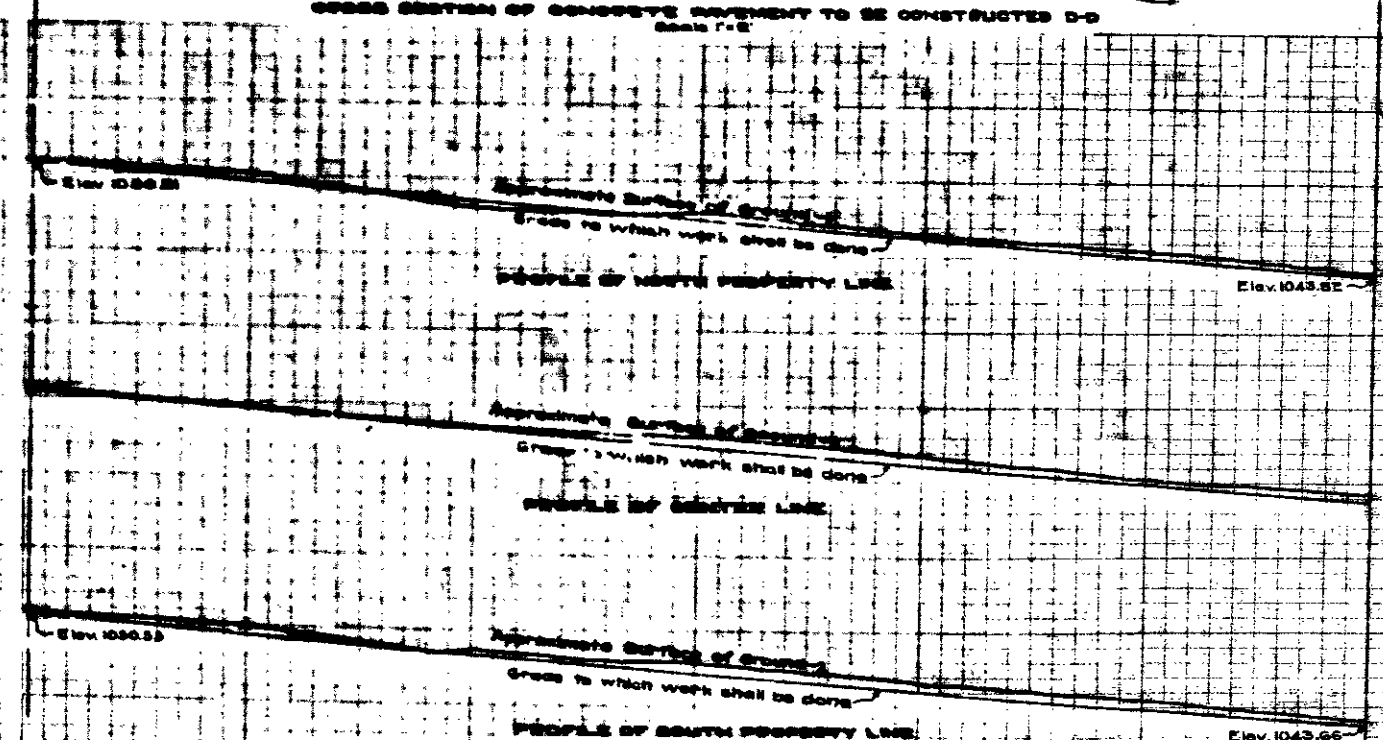

*ft. in means feet or inches.
 No. 713 means foot or feet.
 St. means Street.
 Elev. means Elevation.
 4' Concrete Pavement to be constructed at this point.
 Cross Section of Pavement to be constructed shown there.

All elevations in feet are in feet and inches thereof and above a plane which is 1043.62 below the city bench mark as established by ordinance No. 383 of the City of San Bernardino, California.

Title of Waters St. to City of San Bernardino, by Dedication of Waters Subdivision in City of San Bernardino. Recorded in Book of Maps No. 6 Page 47 in Recorder's Office for County of San Bernardino.

Grade of Waters Street established October 24, 1924, Ordinance No. 115.

Plan adopted November 17, 1924.

Black Line shows approximate surface of ground.
 Red Line shows grade to which work shall be done.
 Scale: Horizontal 1" = 40', Vertical 1" = 6'

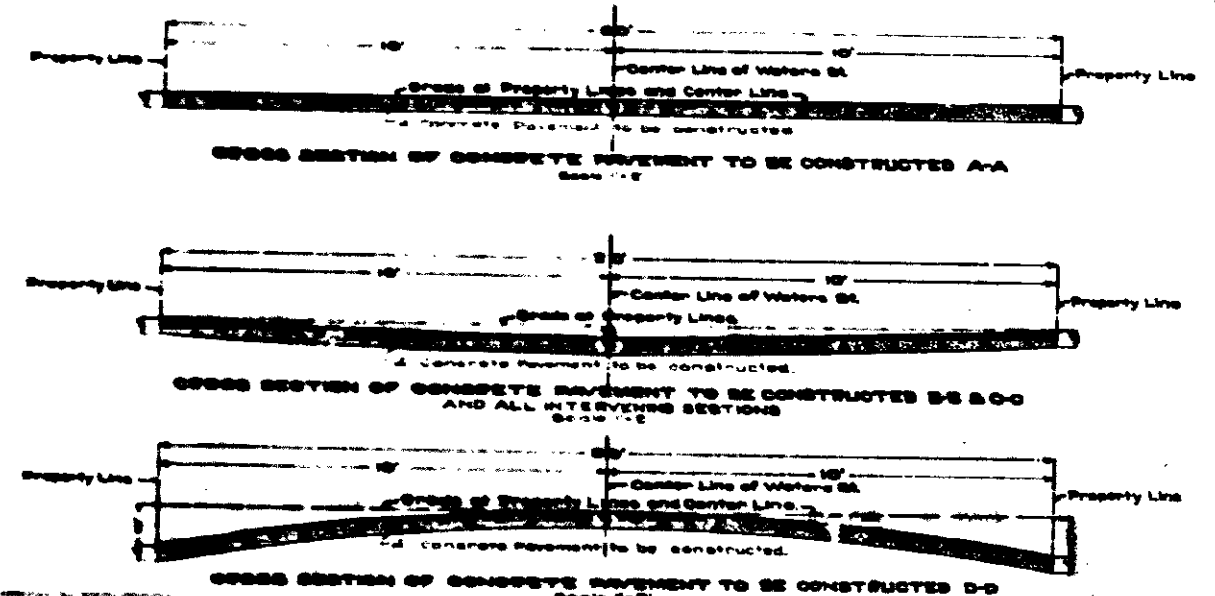
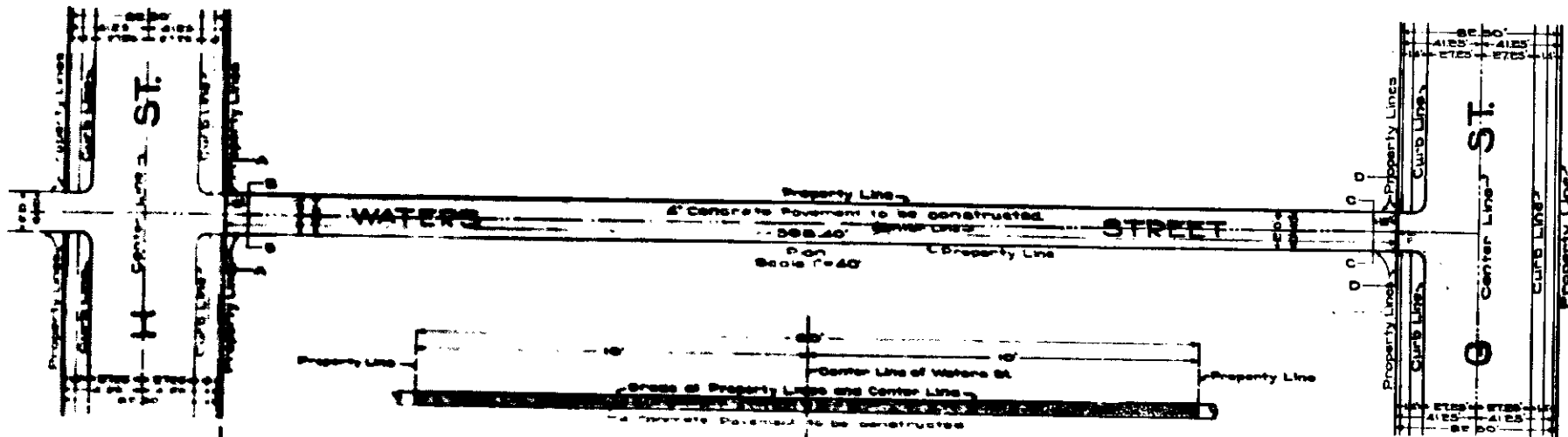

FILED

PLAN & PROFILE No. 713
 FOR
IMPROVEMENT
 OF
WATERS STREET
 FROM G ST. TO H ST.
 IN THE
CITY OF SAN BERNARDINO,
 CALIFORNIA.

October, 1924. C.E. Johnson, City Engineer

Scale:
 Plan 1"=40'
 Profile (Horizontal) 1"=40'
 Profile (Vertical) 1"=6'

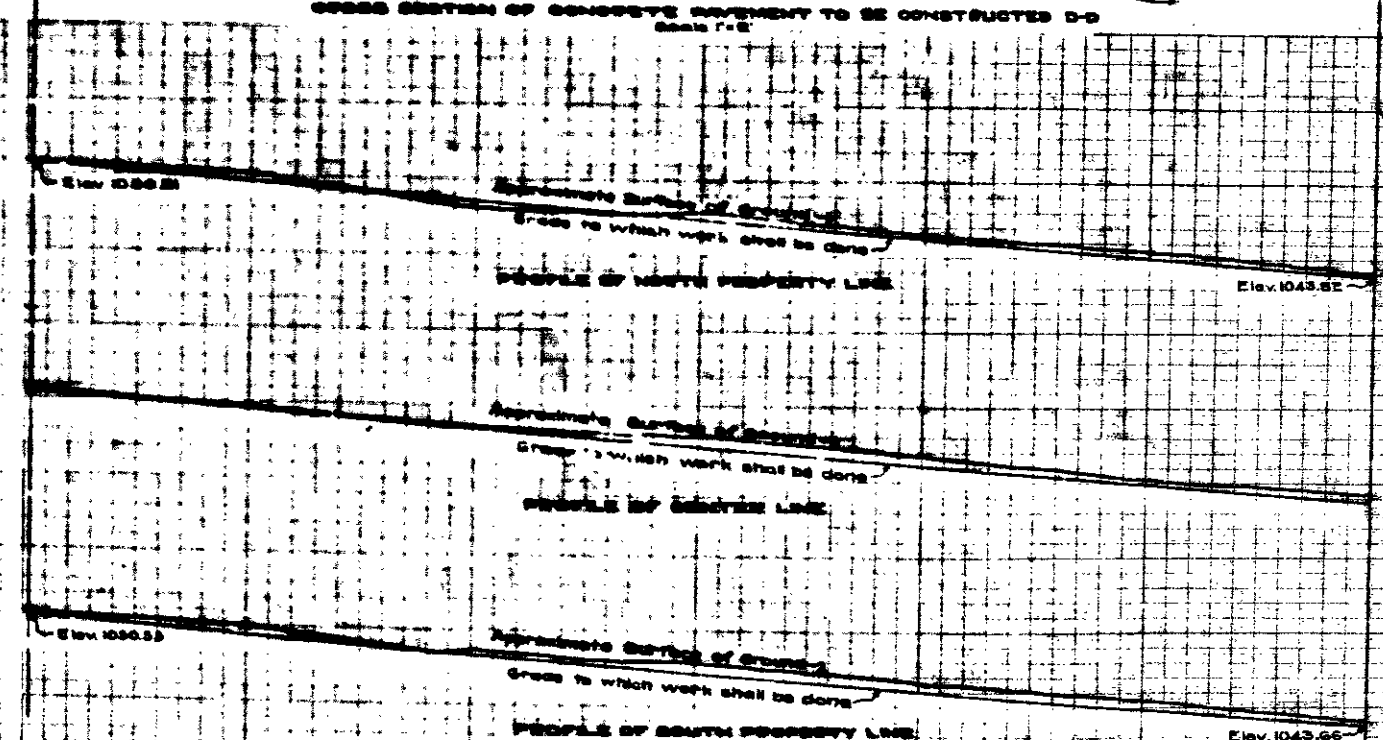

*ft. in means feet or inches.
 sp. ft. means feet or feet.
 No. means number.
 St. means Street.
 Elev. means Elevation.
 4' Concrete Pavement to be constructed at this thickness.
 Cross Section of Pavement to be constructed shown there.

All elevations in feet are in feet and inches thereof and above a plane which is 1043.52 below the city bench mark as established by ordinance No. 383 of the City of San Bernardino, California.

Title of Waters St. to City of San Bernardino, by Dedication of Waters Subdivision in City of San Bernardino. Recorded in Book of Maps No. 6 Page 47 in Recorder's Office for County of San Bernardino.

Grade of Waters Street established October 24, 1924, Ordinance No. 315.

Plan adopted November 17, 1924.